

# INTEX® OWNER'S MANUAL

## FastFill™ Airbed with 2-step battery inflation system

### Model I638AA 4AA Cell Size Batteries 6V ---

#### IMPORTANT SAFETY INSTRUCTIONS

**READ AND FOLLOW ALL INSTRUCTIONS BEFORE USING THIS PRODUCT**

## **WARNING**

To reduce the risk of burns, fire, electric shock, or injury to persons:

- Infants have suffocated on inflatable mattresses. Never place infant aged birth to 15 months to sleep on this inflatable air mattress / air bed. Infants can suffocate on an underinflated or deflated mattress, on bedding, by co-sleeping with another person, and by entrapment between the mattress and bed frame or between the mattress and a vertical surface.
- Children can be entrapped between the inflatable mattress and an adjacent vertical surface. Provide at least a shoulder width space between the inflatable mattress / airbed and adjacent vertical surfaces such as walls, dressers or other objects.
- Always keep the inflatable mattress fully inflated when in use.
- Never introduce any flammable substance into the inflatable airbed, SUCH AS AEROSOL TIRE REPAIR PRODUCTS, as it may ignite or explode.
- Close supervision is necessary when this furnishing is used by, or near children, invalids, or disable persons.
- Use this furnishing only for its intended use as described in these instructions. Do not use attachments not recommended by the manufacturer.
- Do not operate where aerosol (spray) products are being used or where oxygen is being administered.
- This is not a toy. Children must not be left unattended when using the airbed.
- If a storage bag is included, keep the storage bag away from babies and children. The storage bag is not a toy. When not in use, fold the bag and put it away out of the reach of children.
- Do not walk, stand on or jump on or use the airbed as a trampoline.
- Do not use on or near water. This is not a raft.
- Do not set up bed near stairs, doors, sharp edges or breakable objects. Provide adequate space between bed and objects to avoid entrapment.
- Make sure the area is flat, smooth, free of sharp objects that could puncture the bed and keep away from ledges.
- Keep pets away from the airbed. Pets may puncture the surface of the bed.
- Avoid sleeping on the edge of the airbed. Edges produce less support than the middle of the bed.
- Do not operate air pump for more than 5 minutes at a time. Let pump cool at least 15 minutes between uses.
- Never operate the furnishing with the air openings blocked. Keep the air openings free of lint, hair, and the like. Never drop or insert object into any opening.
- Do not dispose of the batteries in regular trash, municipal waste stream or by fire as battery may leak or explode. Always dispose of the batteries safely in accordance with your local law and regulations.
- Never recharge non-rechargeable batteries.
- Do not short-circuit the terminals of the battery or rechargeable battery.

**FOLLOW THESE RULES AND ALL INSTRUCTIONS TO AVOID SUFFOCATION, PROPERTY DAMAGE, ELECTRIC SHOCK, BURNS OR OTHER INJURY.**

©2021 Intex Marketing Ltd. - Intex Development Co. Ltd. - Intex Recreation Corp. All rights reserved/Tous droits réservés/Todos los derechos reservados/Alle Rechte vorbehalten. Printed in China/Imprimé en Chine/Impreso en China/Gedruckt in China.

®™ Trademarks used in some countries of the world under license from/®™ Marques utilisées dans certains pays sous licence de/Marcas registradas utilizadas en algunos países del mundo bajo licencia de/Warenzeichen verwendet in einigen Ländern der Welt in Lizenz von/Intex Marketing Ltd. to/à/a/an Intex Development Co. Ltd., Hong Kong & Intex Recreation Corp., P.O. Box 1440, Long Beach, CA 90801 • Distributed in the European Union by/Distribué dans l'Union Européenne par/Distribuido en la unión Europea por/Vertrieb in der Europäischen Union durch/Intex Trading B.V., Venneveld 9, 4705 RR Roosendaal - The Netherlands  
www.intexcorp.com

**INTEX®**

# READ AND SAVE THESE INSTRUCTIONS

## OPERATING INSTRUCTIONS

38PO

### General

- This airbed is ideal for temporary indoor and outdoor use particularly when no electrical power outlet is readily available.
- This product operates on four (4) replaceable AA size batteries (not included).
- For maximum power use alkaline batteries. Remove batteries from equipment which is not to be used for an extended period of time.
- Do not mix old and new batteries. Do not mix alkaline, standard (Carbon - Zinc), or rechargeable (Nickel - Cadmium) batteries.
- Remove used batteries promptly.
- Keep away from heat or direct sunlight.
- Always purchase the correct size and grade of battery most suitable for the intended use.
- Replace all batteries of a set at the same time.
- Clean the battery contacts and also those of the device prior to battery installation.
- Ensure batteries are installed correctly with regard to polarity (+ and -).
- If leaking battery liquid (electrolyte) comes in contact with skin, wash immediately with soap and water or neutralize it with vinegar or lemon juice. In case of contact with eyes, rinse immediately with plenty of water for 10 minutes and seek medical advice.
- Make sure the area is flat, level, clean and free from sharp objects. To prevent puncture or damage to the airbed, never drag the airbed across the ground. Lift the inflated airbed when moving or changing location.
- During outdoor use, place a protective layer such as a tarp (not included) between the selected surface and the airbed in order to prevent damage to the airbed.

### Maintenance instructions:

- No specific air pump maintenance is required.
- For airbed cleaning use only clean cloth with mild soapy solution. Do not use any chemicals.
- In case of repairs, use only common PVC repair glue and patches. For flocked surfaces: rub away the flocking material with an eraser first before applying the glue and/or patch.

## IMPORTANT NOTE

Proper inflation of the airbed.

The ambient temperatures of air have an effect on the airbed internal pressure. At low ambient temperature the air will contract within the airbed and the airbed will feel softer: add air as necessary. At high ambient temperature the air within the airbed will expand significantly and the airbed will become hard and may burst: release air to avoid damage to the airbed or to soften the feel. **Do not** expose the airbed to extreme temperatures (hot or cold). Stretching is a natural characteristic of new vinyl. During initial use, the airbed may become soft and require additional inflation to maintain desired firmness. This is normal for the first few days of use. Dimensions shown are approximate and will vary due to the vinyl temperature and the air temperature.

**In no event shall Intex, their authorized agents or employees be liable for damages (such as pin holes) to the airbed caused by negligence, ordinary wear and tear, abuse and carelessness, or external forces.**



## CAUTION

- To reduce the risk of electric shock or injury, do not expose to rain. Store indoors.

## READ AND SAVE THESE INSTRUCTIONS

## PARTS REFERENCE

38PO

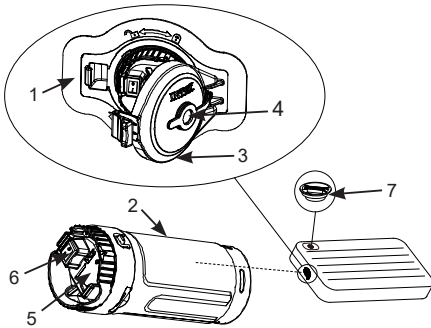

1. Pump holder frame
2. Electric air pump  
(Part number: #12991)
3. Electric air pump cover
4. Manual inflation port and cap
5. Battery cover
6. Power switch
7. Built-in pressure adjuster cap  
(part number: #13142)

**NOTE:** Drawings for illustration purpose only. Actual product may vary. Not to scale. Due to a policy of continuous product improvement, Intex reserves the right to change specifications and appearance, which may result in updates to the instruction manual, without notice.

### BATTERY INSTALLATION

1. Unfold the airbed and open the electric air pump cover (3) to reveal the electric air pump (2). See Fig (1).
2. Remove the electric air pump by turning the air pump rim counterclockwise, and pull the air pump out. See Fig (1).
3. Open the battery cover (5), insert 4 "AA" alkaline batteries (NOT INCLUDED) as shown on the drawings inside the battery compartment, close and latch the battery cover. See Fig (2).

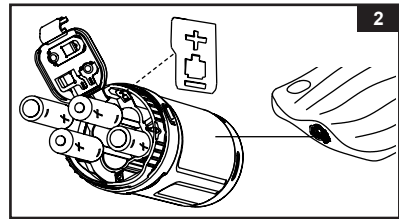
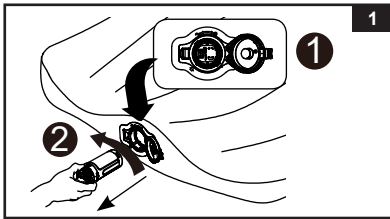

4. Insert the electric air pump in the airbed by aligning the arrow on the pump body with the arrow on the pump holder frame (1). Turn the air pump clockwise to lock it. See Fig (3-4).

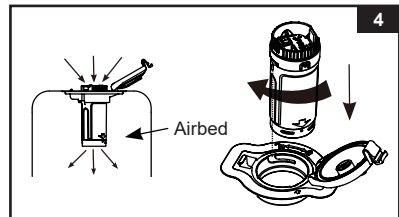
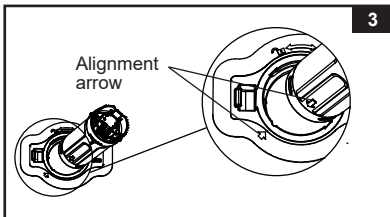

# READ AND SAVE THESE INSTRUCTIONS

**INFLATION****USING THE ELECTRIC AIR PUMP AND TOP OFF THE FIRMNESS WITH THE BUILT-IN PRESSURE ADJUSTER**

**NOTE:** The electric pump is a low pressure inflator. Start by inflating the airbed using the electric air pump until the sides are up and then use the built-in pressure adjuster to reach your desired firmness.

1. Locate the built-in pressure adjuster and unscrew the cap (7). See Fig (5).
2. Make sure the manual inflation port cap (4) on the electric air pump cover (3) is closed by pushing in firmly. See Fig (6).

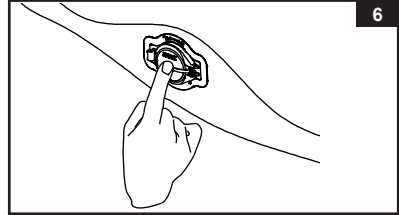
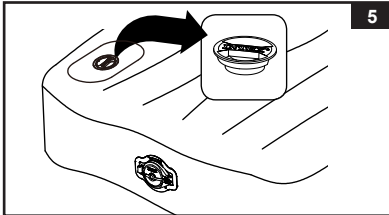

3. Open the electric air pump cover (3) and turn the switch ON to inflate the airbed until the airbed side walls are up. See Fig (7). The airbed will take shape but still feel soft.
4. To switch off the pump, simply close and latch the electric pump cover (3) and the pump will stop. See Fig (8).

**IMPORTANT:** Do not just turn the switch OFF with your finger as this will allow the air to escape. Close the large electric air pump cover while the pump is still operating to switch OFF.

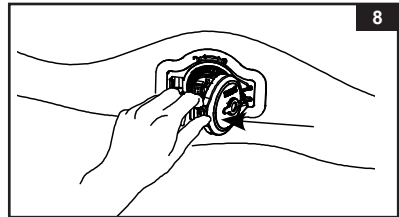
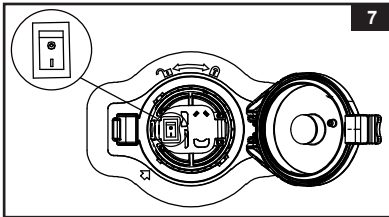

# READ AND SAVE THESE INSTRUCTIONS

5. Top off with hands or foot, whichever is more convenient. Place your hands or foot directly over the pressure adjuster valve opening, covering the opening completely, and press down firmly. This will push air from the air pump chamber into the bed. See Fig (9).

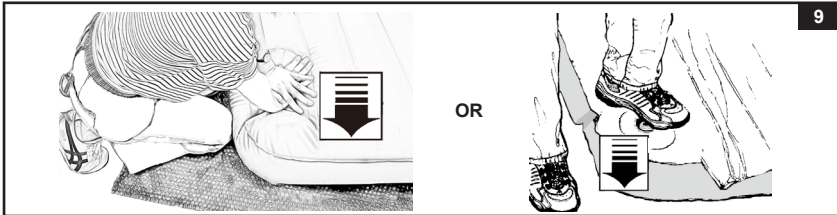

6. Remove your hands or foot so the air pump chamber will re-fill with air for the next cycle. See Fig (10).  
 7. Repeat until the desired firmness is achieved.  
 8. Replace the built-in pressure adjuster cap (7).

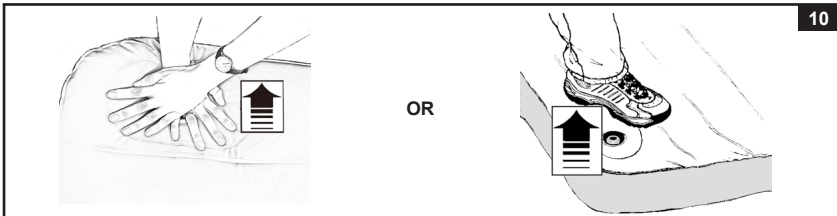

## MANUAL INFLATION OPTION

A conventional external foot, manual or electric operated air pump (not included) can be used by connecting it to the manual inflation port located on the electric air pump cover (3). See Fig (11). Follow these steps:

1. Unscrew the built-in pressure adjuster cap (7).
2. Make sure the electric air pump cover (3) is latched closed. To prevent misplacing or damage to the electric air pump (2), the pump should be properly attached.
3. Remove the cap from the manual inflation port (4) and insert the nozzle of the pump into the port. Inflate the airbed to desired firmness.  
**NOTE:** To prevent bursting, do not over inflate or use high pressure air compressor.
4. Remove nozzle from manual inflation port and close the cap firmly.
5. Screw the built-in pressure adjuster cap (7) back on.

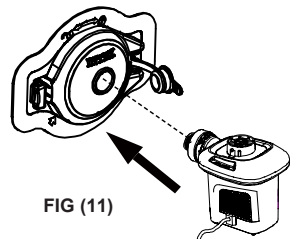

# READ AND SAVE THESE INSTRUCTIONS

## POWER DEFLATION

1. Open the air pump cover (3) and remove the electric air pump (2) from the airbed. The open port will start deflating the airbed naturally. See Fig (12).
2. Switch ON the pump by pressing "I" and reattach it to the airbed in the reverse direction: With the power switch facing the airbed, align the arrow on the pump rim with the arrow on the pump holder frame and turn pump clockwise to lock in place. The pump is only slightly recessed with the pump body sticking out of the airbed for deflation. See Fig (13).

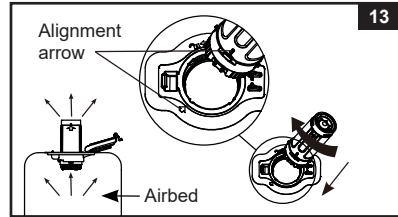
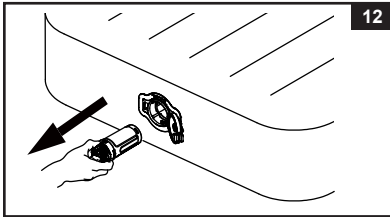

3. With the airbed fully deflated begin rolling the airbed from the end opposite of the pump towards the end where the pump is located. See Fig (14).
4. Remove the electric air pump from the airbed and switch it OFF. Now re-attach the pump in its original fully recessed position: With the power switch facing away from the airbed, align the arrow on the pump body with the arrow on the pump holder frame (1) and reattach the air pump to the airbed. Turn the air pump clockwise to lock it and close the air pump cover (3).



FIG (14)

## MANUAL DEFLATION

1. Open the air pump cover (3) and remove the electric air pump (2) from the airbed. See Fig (12).
2. Begin rolling the airbed from the end opposite of the pump towards the end where the pump is located. See Fig (14).
3. With the power switch facing away from the airbed, align the arrow on the pump body with the arrow on the pump holder frame (1) and reattach the air pump to the airbed. Turn the air pump clockwise to lock it and close the air pump cover (3).

# READ AND SAVE THESE INSTRUCTIONS

## STORAGE INSTRUCTIONS

1. Deflate the airbed following the "DEFLATION" instructions.
2. Make sure the airbed is clean and dry.
3. Lay the airbed flat with the sleeping surface facing upwards and follow the folding steps on Figs (15 - 19). Fold the airbed loosely and avoid sharp bends, corners and creases which can damage the airbed.



FIG (15)



FIG (16)



FIG (17)

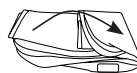

FIG (18)



FIG (19)

4. Place the airbed inside the storage bag (if included) or the original packaging and store in a dry place.

## TROUBLESHOOTING GUIDE

PROBLEM	CAUSE	SOLUTION
Electric air pump is not working / pump motor not running.	<ul style="list-style-type: none"> <li>• Batteries are depleted, low in power.</li> <li>• Check batteries are correctly installed.</li> <li>• Battery cover is not securely latched.</li> <li>• Power switch is off.</li> <li>• Dirt, lint, hair or object inside the electric air pump.</li> </ul>	<ul style="list-style-type: none"> <li>• Change to a new set of batteries.</li> <li>• Ensure batteries are installed correctly with regard to polarity (+ and -).</li> <li>• Push in the battery cover firmly.</li> <li>• Turn on the power switch.</li> <li>• Remove any dirt, lint, hair, etc inside the electric air pump.</li> </ul>
After inflation, air flows out when turning the electric air pump power switch off with the finger.	<ul style="list-style-type: none"> <li>• Incorrect way to turn off the electric air pump.</li> </ul>	<ul style="list-style-type: none"> <li>• Simply close the electric air pump cover while the pump is still operating to switch OFF. Make sure the cover is securely latched.</li> </ul>
Air is leaking around the electric air pump cover.	<ul style="list-style-type: none"> <li>• Electric air pump cover not securely closed and latched.</li> <li>• Dirt, dust, etc on the electric air pump cover O-ring.</li> </ul>	<ul style="list-style-type: none"> <li>• Check the electric air pump is fully inserted and locked in place. Close and latch the electric air pump cover.</li> <li>• Make sure there is no dirt, dust, lint, hair on the electric air pump cover O-ring.</li> </ul>
Air is leaking around the manual inflation port cap.	<ul style="list-style-type: none"> <li>• Manual inflation port cap is not securely closed.</li> </ul>	<ul style="list-style-type: none"> <li>• Push the manual inflation port cap firmly in.</li> </ul>
Air is leaking around the built-in pressure adjuster cap.	<ul style="list-style-type: none"> <li>• Built-in pressure adjuster cap is not securely tightened.</li> </ul>	<ul style="list-style-type: none"> <li>• Make sure the built-in pressure adjuster cap is securely tightened.</li> </ul>

# READ AND SAVE THESE INSTRUCTIONS